

CERAMIC WALL CW1

SC 1:5

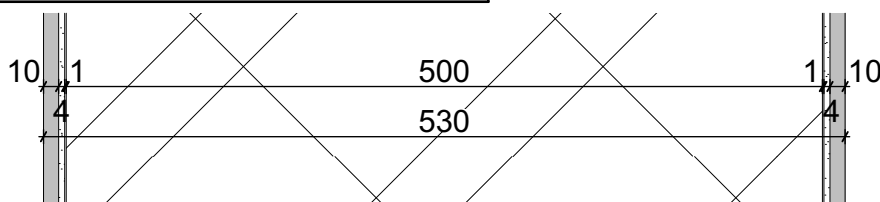

COMPOSITION OF BATHROOM WALL HELUZ 50

N	FUNCTION	MATERIAL SPECIFICATION	STABILIZATION	THICKNESS
1	GROUTING MORTAR	FLEXIBLE GROUTING MORTAR curing time 24 hours, flexural strength $\geq 2.5 \text{ N/mm}^2$, compressive strength $\geq 15 \text{ N/mm}^2$	rubber trowel	-
2	SURFACE FINISH	CERAMIC TILES dimenstions 30 x 30 cm, coefficient of thermal conductivity $\lambda_u 1.01 \text{ W/m}^2\text{K}$, diffusion resistance factor $\mu > 0.5$, anti-slip R11	-	10
3	TILE ADHESIVE	CEMENTITIOUS ADHESIVE WITH EXTENDED OPEN TIME AND REDUCED SLIP curing time 24 hours, consumption 3-5 kg/m ² , 4 mm in case of 30x30cm tiles, tensile adhesion strength $\geq 1.0 \text{ N/mm}^2$, fire reaction class A1, slip $>0.5 \text{ N/mm}^2$	stainless steel trowel	4.0
4	WATERPROOFING	ACRYLIC EMULSION BASED, ONE COMPONENT ELASTIC WATERPROOFING curing time 4 hours, consumption 1.5 kg/m ² , 3 layers, tensile strength $\geq 0.8 \text{ N/mm}^2$, tensile adhesion strength $\geq 0.8 \text{ N/mm}^2$, water-vapour permeability class I, equivalent air thickness $S_d < 5$	brush or roller	1.0
5	PENETRATION	ACRYLIC PRIMER ready to use acrylic based primer, temperature range (+5°C)-(+35°C), mininum drying time 45-60 minutes, pot life 20 minutes, consumption 150 gr/m ² , 2 layers needed	roller, brush or spraying machine	-
6	LOAD-BEARING	LOAD-BEARING MASONRY BRICK monolayer load-bearing brick, heat transfer coefficient $U 0.11 \text{ W/m}^2\text{K}$, thermal resistance $R 9.16 \text{ m}^2\text{K/W}$, coefficient of thermal conductivity $\lambda_u 0.058 \text{ W/m}^2\text{K}$, fire reaction class B-s1,d0, fire resistance REI 30 DP1/90 DP3, airborne noise $R_w 44(-1,-2)$, diffusion resistance factor $\mu 9.71$	-	500
7	PENETRATION	ACRYLIC PRIMER ready to use acrylic based primer, temperature range (+5°C)-(+35°C), mininum drying time 45-60 minutes, pot life 20 minutes, consumption 150 gr/m ² , 2 layers needed	roller, brush or spraying machine	-
8	WATERPROOFING	ACRYLIC EMULSION BASED, ONE COMPONENT ELASTIC WATERPROOFING curing time 4 hours, consumption 1.5 kg/m ² , 3 layers, tensile strength $\geq 0.8 \text{ N/mm}^2$, tensile adhesion strength $\geq 0.8 \text{ N/mm}^2$, water-vapour permeability class I, equivalent air thickness $S_d < 5$	brush or roller	1.0
9	TILE ADHESIVE	CEMENTITIOUS ADHESIVE WITH EXTENDED OPEN TIME AND REDUCED SLIP curing time 24 hours, consumption 3-5 kg/m ² , 4 mm in case of 30x30cm tiles, tensile adhesion strength $\geq 1.0 \text{ N/mm}^2$, fire reaction class A1, slip $>0.5 \text{ N/mm}^2$	stainless steel trowel	4.0
10	SURFACE FINISH	CERAMIC TILES dimenstions 30 x 30 cm, coefficient of thermal conductivity $\lambda_u 1.01 \text{ W/m}^2\text{K}$, diffusion resistance factor $\mu > 0.5$, anti-slip R11	-	10
11	GROUTING MORTAR	FLEXIBLE GROUTING MORTAR curing time 24 hours, flexural strength $\geq 2.5 \text{ N/mm}^2$, compressive strength $\geq 15 \text{ N/mm}^2$	rubber trowel	-

NOTES:

- 5, 7 painted on clean, flat (maximal deviation 30 mm), dry, degreased surface in temperatures higher than 5 degrees
- 3,9 corners have to be treated by butyl tape, width 100 mm before placing of the adhesive